



SOLO MECH / MULTI MECH

PODIZNI SYSTEMI

LAGER KOLEKCIJA

Karakteristike mekog i tihog kretanja Solo-Mech-a pružaju maksimalnu udobnost u vratima ormara koji se podižu. Vrata ormarića se mogu zaustaviti na željenom nivou postepenim otvaranjem.

Multi-Mech nudi savršeno rešenje za zidne jedinice sa dvostrukim vratima sa svojom potpuno mehaničkom strukturom za najbolje performanse.



DAREX LAGER KOLEKCIJA - OKOV >

Neodvojivi deo elegantnih i funkcionalnih životnih prostora. Jedinstven koncept u mnogim aspektima, od elegancije i funkcionalnosti do praktičnosti i trajnosti.

Učitajte QR code sa desne strane!



Nameštaj Darex Home



#darex_home

SOLO MECH



302501 - BELI

SA SOLO MECH B1 - set



302502 - ANTRACIT

SA SOLO MECH B1 - set



301374 - BELI

SA SOLO MECH C1 - set



301375 - ANTRACIT

SA SOLO MECH C1 - set

MULTI MECH



302503 - BELI
302509 - ANTRACIT

SA MULTI MECH A1 - desni

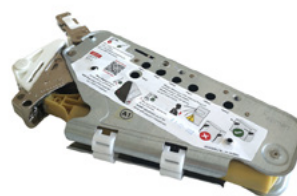

302504 - BELI
302510 - ANTRACIT

SA MULTI MECH A1 - levi



302505 - BELI
302511 - ANTRACIT

SA MULTI MECH B1 - desni



302506 - BELI
302512 - ANTRACIT

SA MULTI MECH B1 - levi



302507 - BELI
302513 - ANTRACIT

SA MULTI MECH C1 - desni



302508 - BELI
302514 - ANTRACIT

SA MULTI MECH C1 - levi



302515 - BELI
302517 - ANTRACIT

SA MULTI MECH Poklopac za opružni mehanizam - desni



302516 - BELI
302518 - ANTRACIT

SA MULTI MECH Poklopac za opružni mehanizam - levi



302519 - BELA
302522 - ANTRACIT

SA MULTI MECH Teleskopska poluga - 195



302520 - BELA
302523 - ANTRACIT

SA MULTI MECH Teleskopska poluga - 237



302521 - BELA
302524 - ANTRACIT

SA MULTI MECH Teleskopska poluga - 345



302525

SA MULTI MECH Šarka 120° sa podloškom



302526

SA MULTI MECH Međušarka sa podloškom



302527

SA MULTI MECH Prihvatnik fronta

TEHNIČKE KARAKTERISTIKE

Podizni sistemi - Solo Mech

Parçalar / Parts

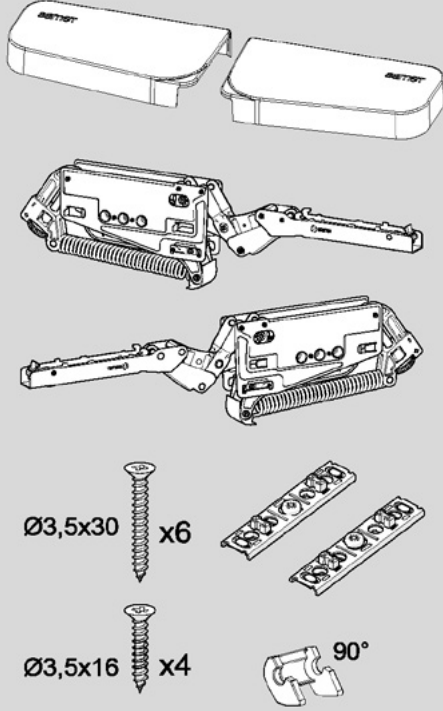

Ürün Seçim Tablosu / Product Selection Table

Mekanizma Mechanism	A1		B1		C1	
	min. Kg	max. Kg	min. Kg	max. Kg	min. Kg	max. Kg
Kabin Yüksekliği Door Height						
200 mm	3,6	6,5	5	9,7	7	14,7
201-250 mm	3,4	5,3	4	7,5	5,5	12,2
251-300 mm	1,9	4,9	3	5,9	4,5	9,9
301-350 mm	1,6	3,6	2,8	5	4	7,9
351-400 mm	1,4	3,1	2,4	4,2	3,6	7,2
401-450 mm	1,3	2,8	2,2	3,8	3,2	6,3
451-500 mm	1,2	2,5	2	3,4	2,8	5,5
501-550 mm	1	2,2	1,75	3	2,6	5,1
551-600 mm	0,95	2	1,7	2,8	2,5	4,6

Kesişen alanlarda daha kuvvetli mekanizma önerilir.
More powerful mechanism is recommended for intersection areas.

Teknik Ölçüler / Technical Dimensions

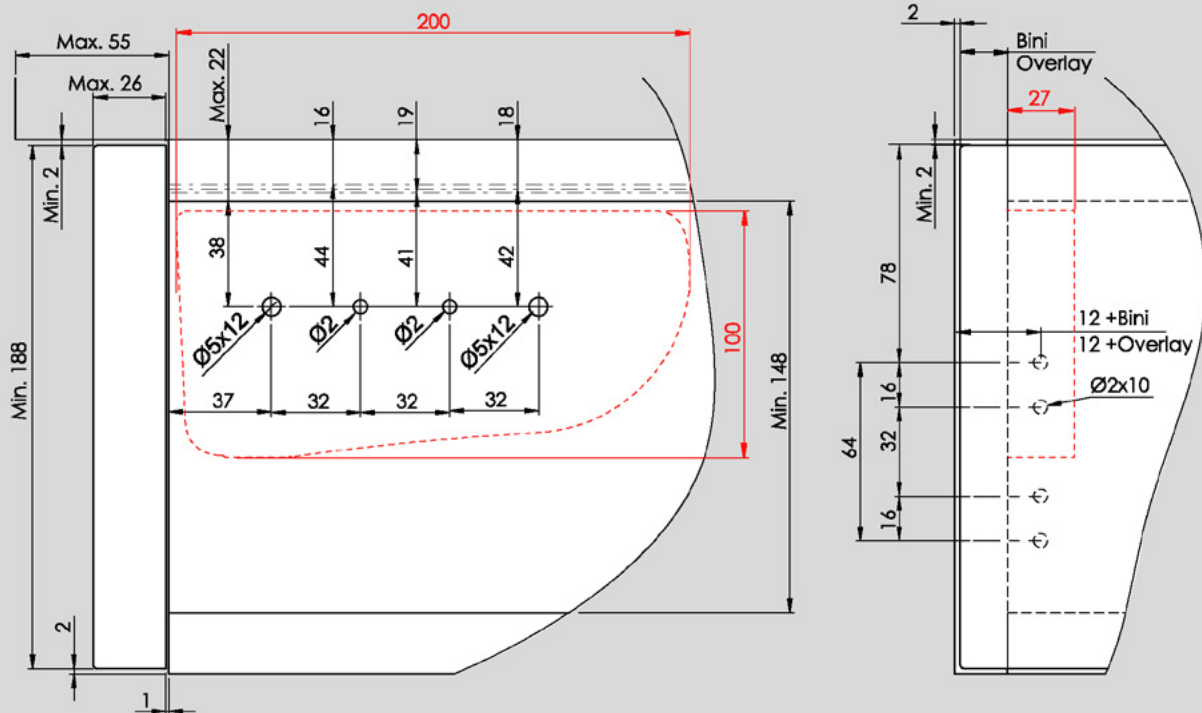

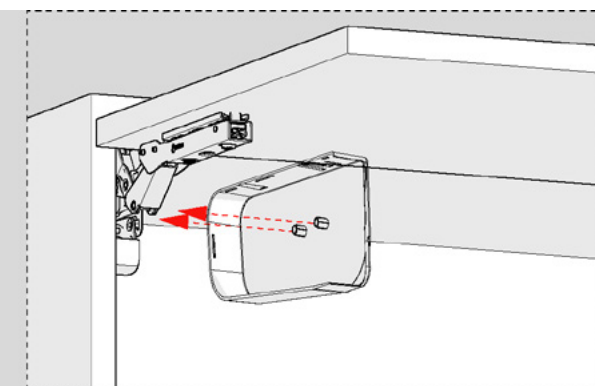
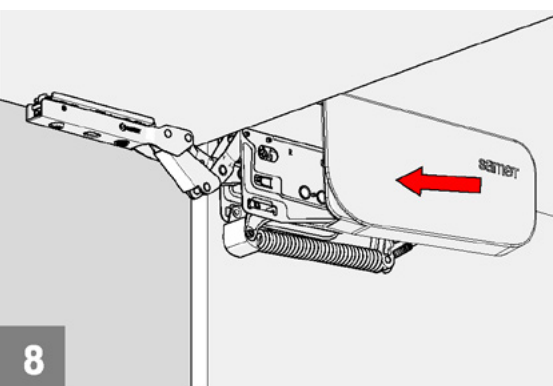
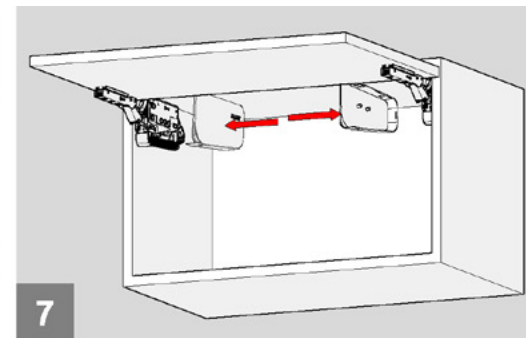
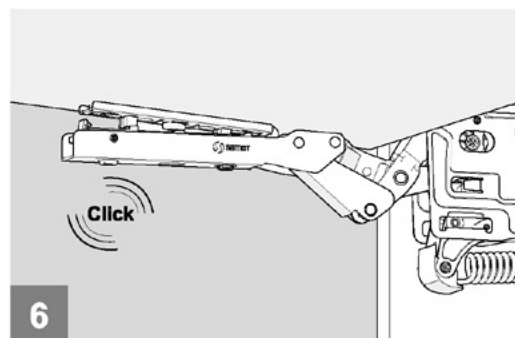
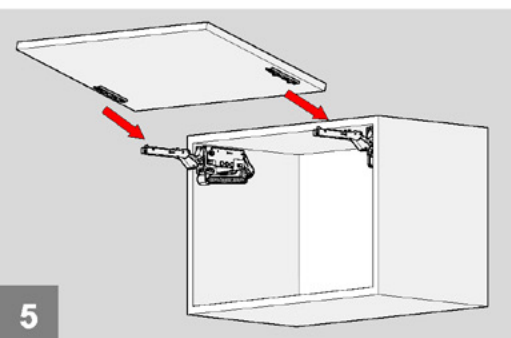
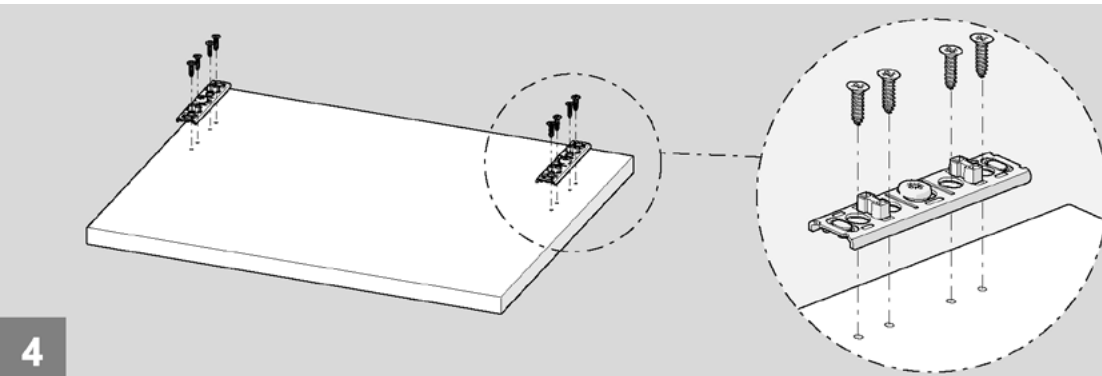
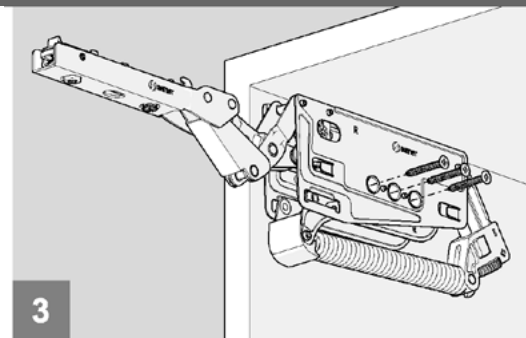
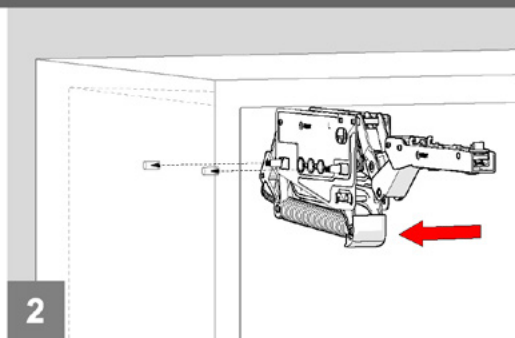
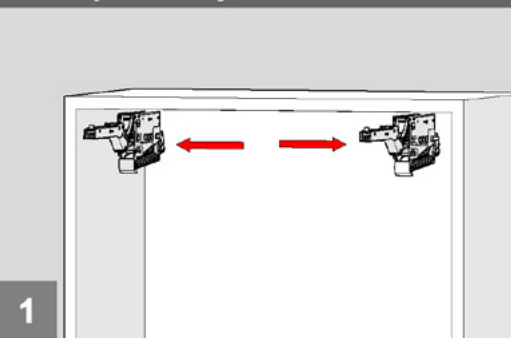

Ayar / Adjustment

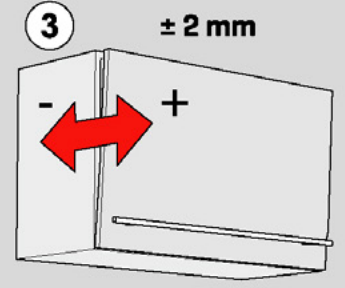
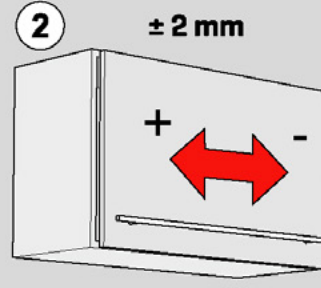
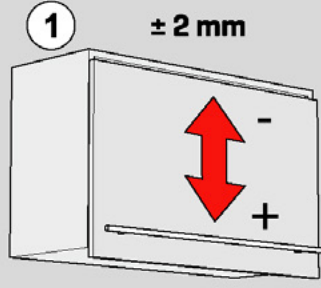
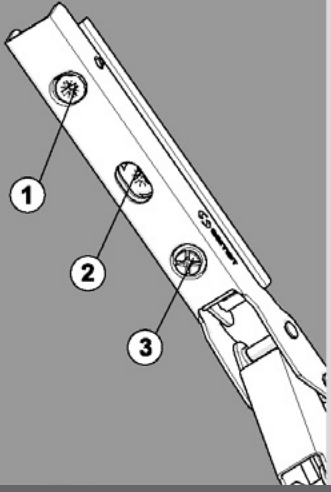

90° Açılma Açısı / 90° Opening Angle

Kapağın 90° açılmasının gerekli olduğu yerler için stoper kullanılır. / The stoper is used to limit the opening to 90°

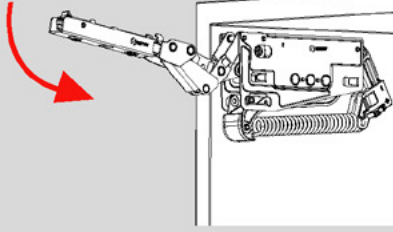

Kolu indiriniz.
Close the arm.

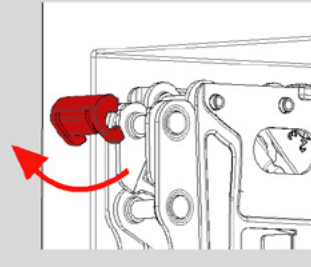
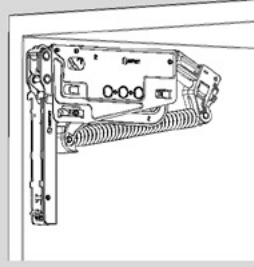

Mevcut stoper parçasını çıkarınız.
Take out the stoper.

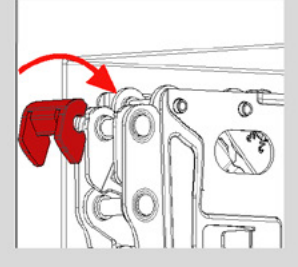

90° Stoper parçasını takınız.
Put 90° Opening angle stoper.



Podizni sistemi - Multi Mech

Technical Dimensions

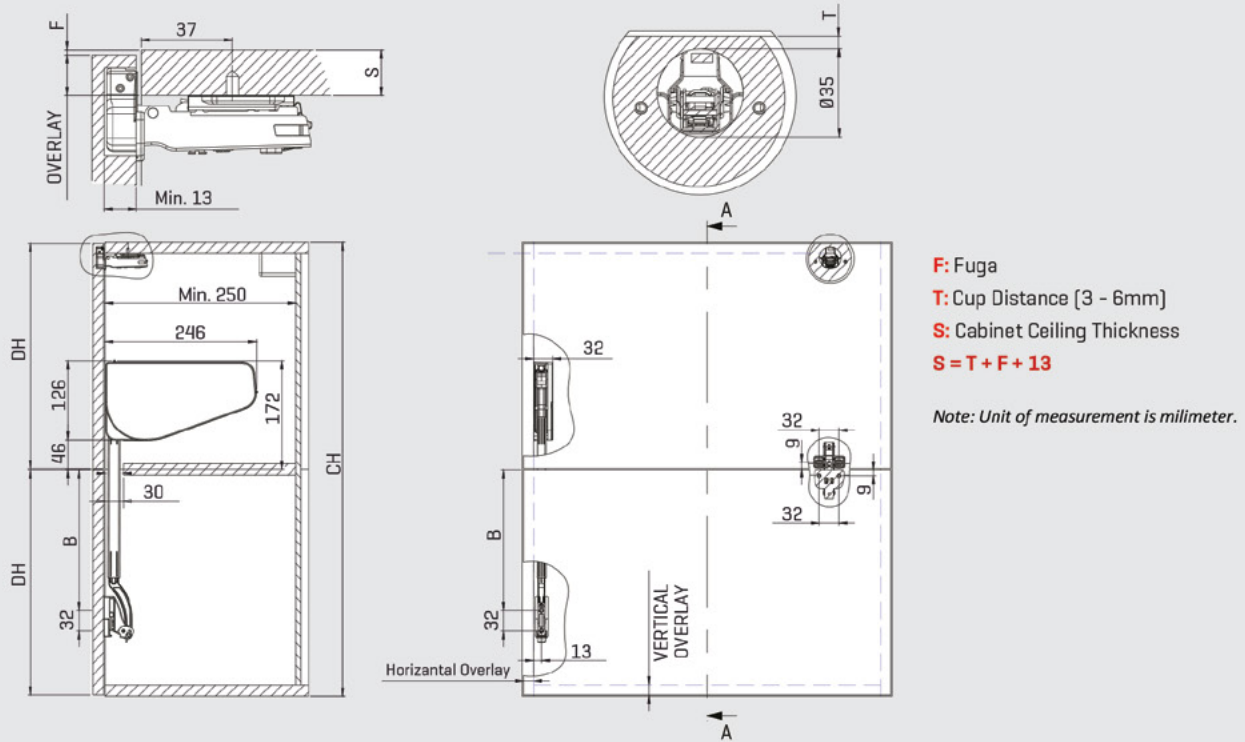

Parts

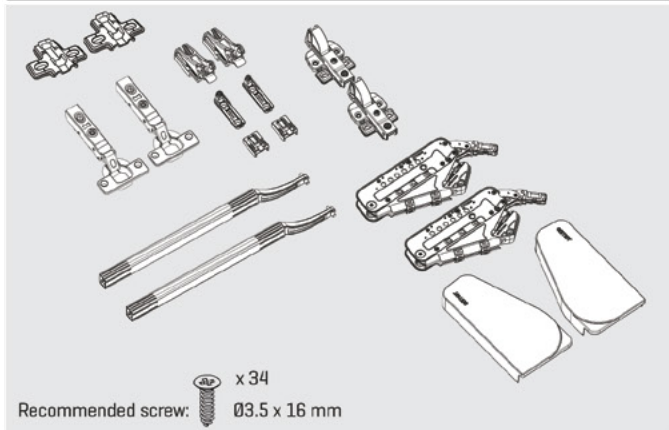

Space Requirement

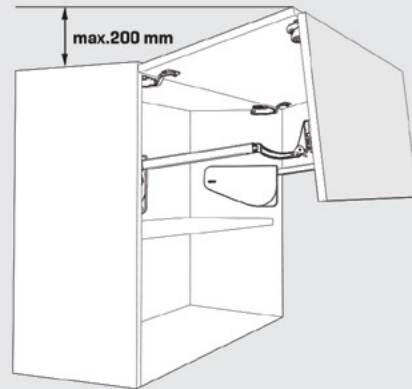

Product Selection Table

Cabinet Height (mm)	LOADING CAPACITY - Two Door Total Weight (Gr.)*					
	Light Load (A1)		Medium Load (B1)		Heavy Load (C1)	
	min.	max.	min.	max.	min.	max.
1001 - 1040	2300	5000	5000	9000	9000	14500
901 - 1000	2400	5500	5500	9500	9500	15000
861 - 900	2500	6000	6000	11000	11000	17000
801 - 860	2600	6500	6500	11500	11500	18000
761 - 800	2800	7200	7200	12500	12500	19000
721 - 760	2900	7500	7500	13000	13000	19500
701 - 720	3200	8000	8000	14000	14000	21000
651 - 700	3500	8500	8500	14500	14500	21500
601 - 650	4000	9000	9000	16000	16000	24000
561 - 600	4500	10000	10000	17000	17000	25000
501 - 560	5000	10500	10500	17500	17500	27000
480 - 500	5500	11500	11500	20000	20000	29000

CABINET HEIGHT (MM)	ARM LENGTH (MM)
480 - 599	145
600 - 699	195
700 - 859	237
860 - 1040	345

*Handle weight is included as 100 gr.

Door Dimensions

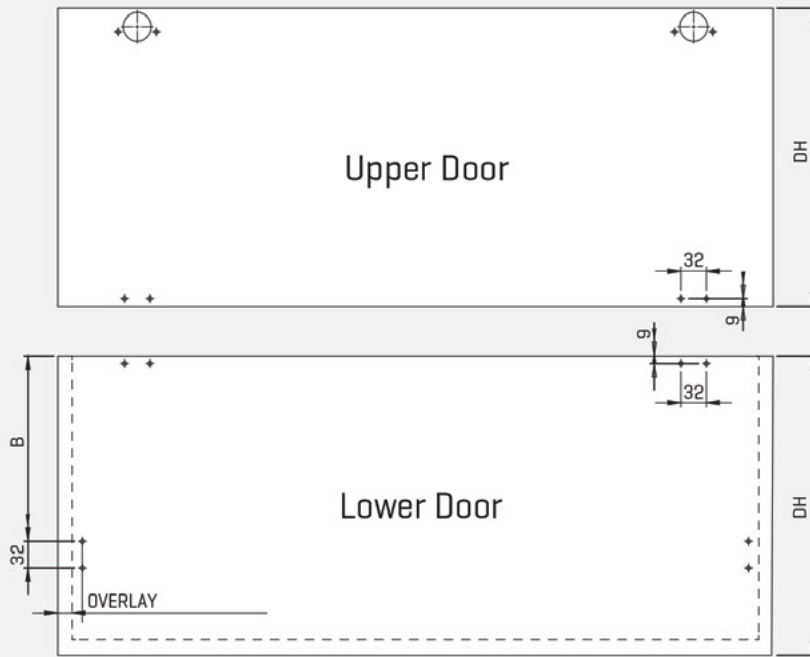

Cabinet Height (mm)	B Distance (mm)
1040	383
1000	366
900	310
860	302
800	260
780	245
720	223
700	212
650	185
600	160
560	143
500	112
480	105

CH: Cabinet Height
DH: Door Height

Cabinet Dimensions

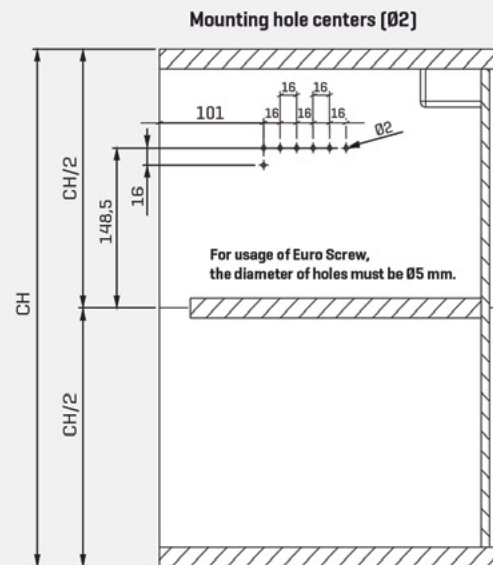
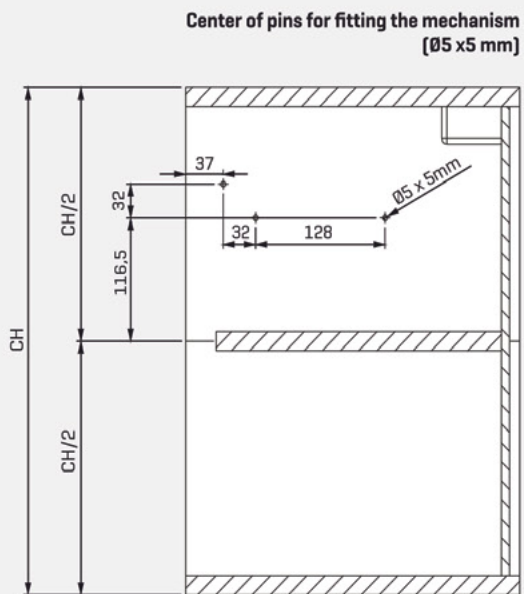

Assembly

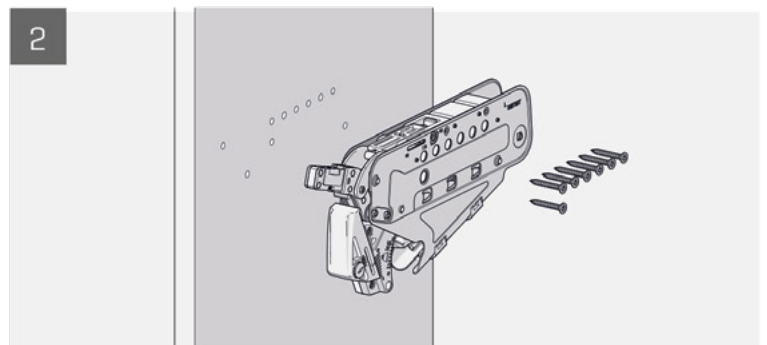
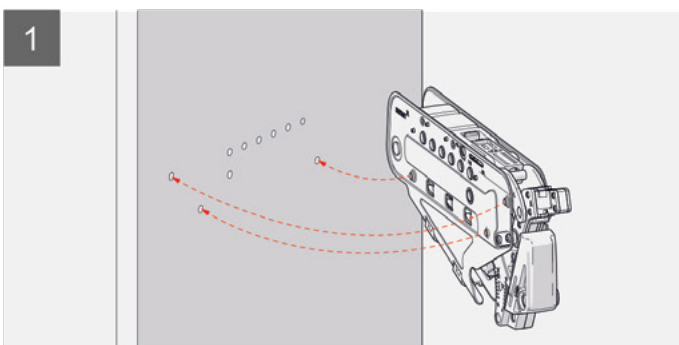

Assembly

3

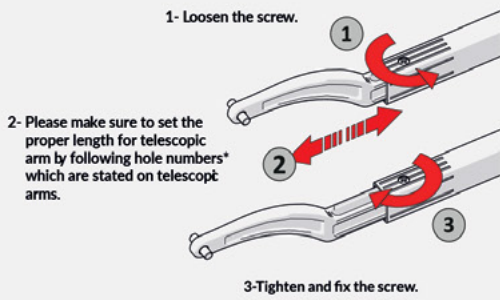

*Please refer to the hole position table for correct hole position.

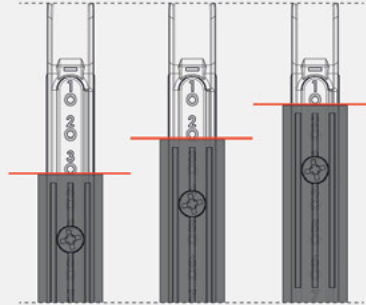

Important:
For setting the correct hole number on telescopic arms, please done the alignment by using the profile edge.

Cabinet Height (mm)	Arm Length (mm)	Hole Number
1040	345	10
1000	345	8
900	345	1
860	345	0
800	255	6
760	255	4
720	255	1
700	255	0
650	195	4
600	195	1
560	145	5
500	145	1
480	145	0

Note: For the cabinet height which is not specified in the table, installation can be done by using the information that is stated in the upper row of the closest dimension to your cabinet height.

4

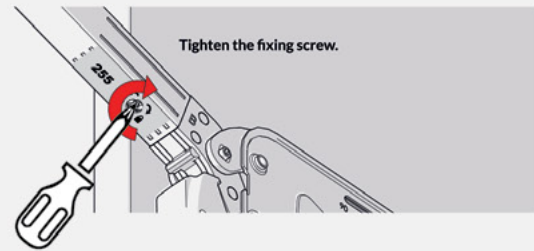
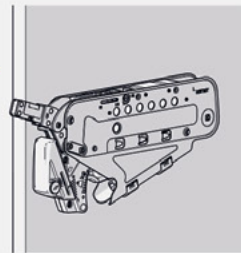
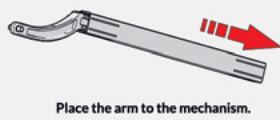

Caution

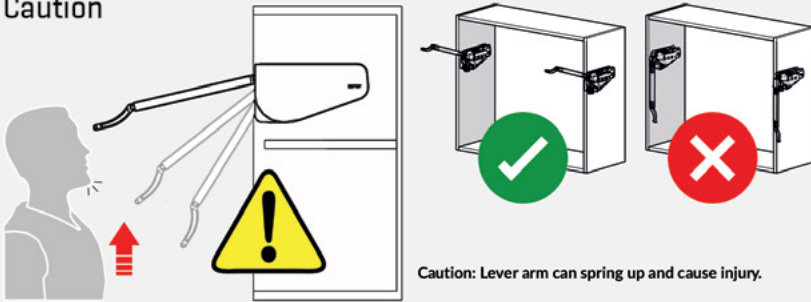

5

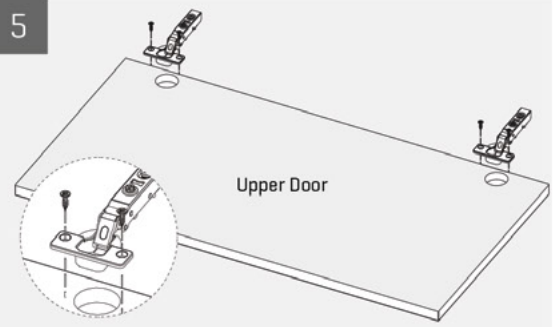

6

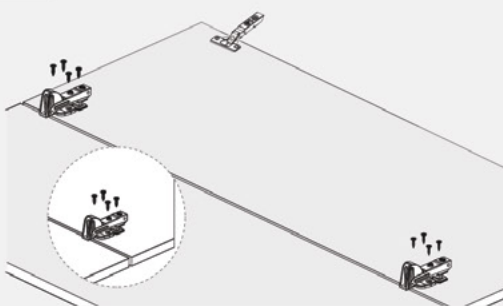

7

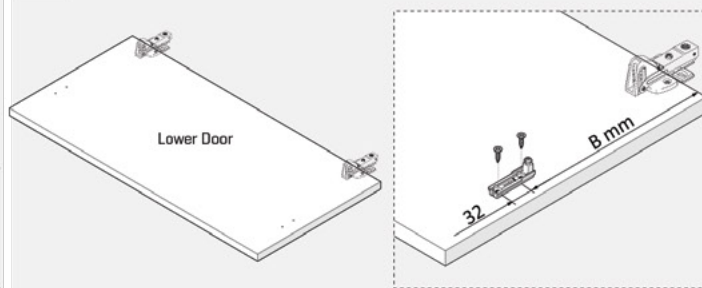

Cabinet Height (mm)	B Distance (mm)
1040	388
1000	366
900	310
860	302
800	260
760	245
720	223
700	212
650	185
600	160
560	143
500	112
480	105

8

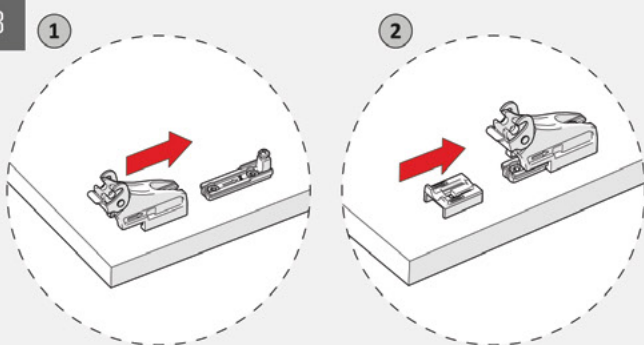

9

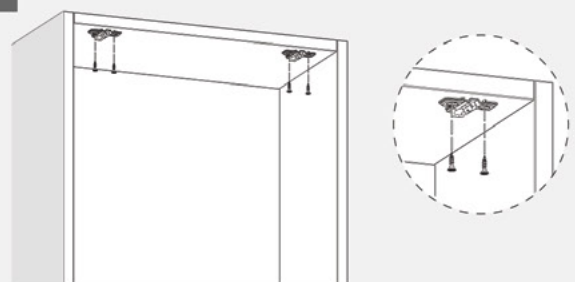

Assembly

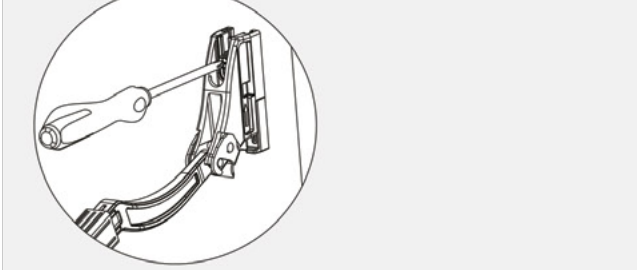
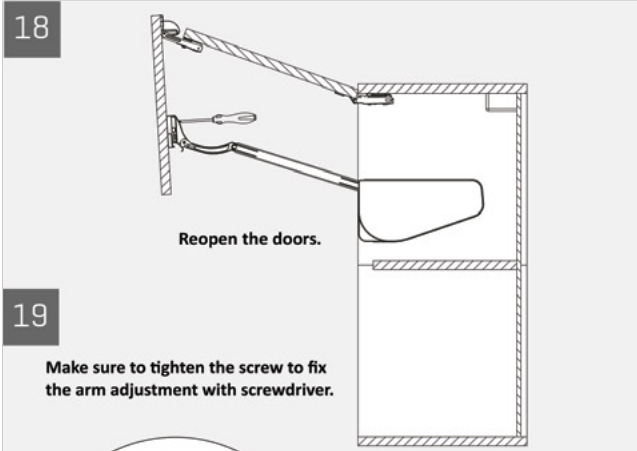
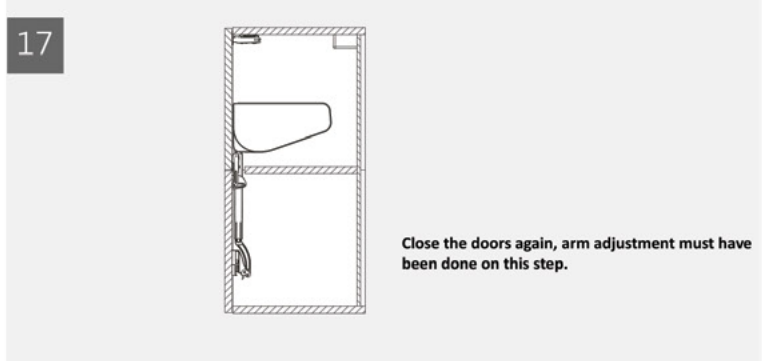
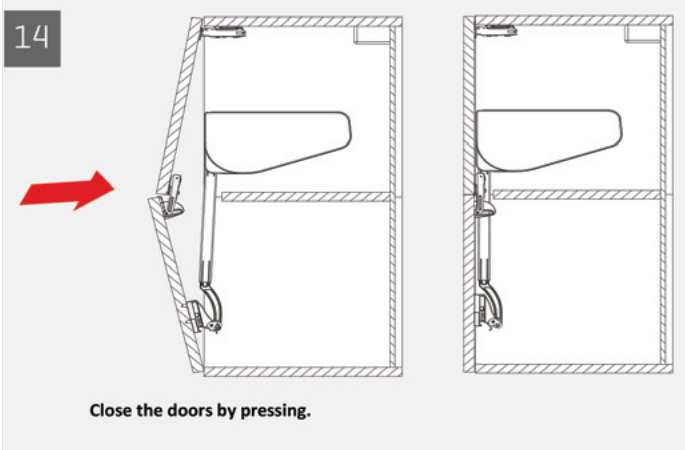
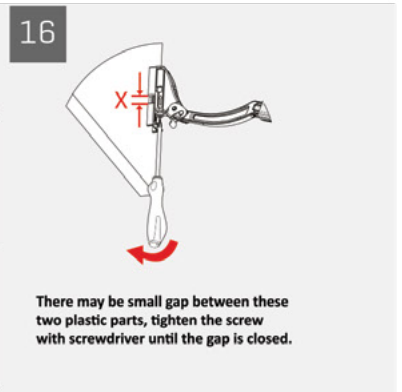
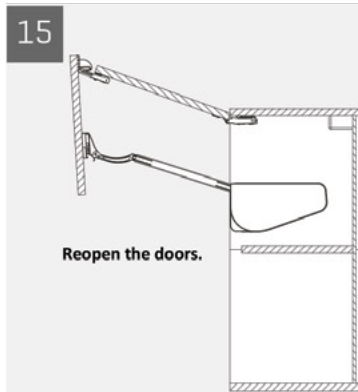
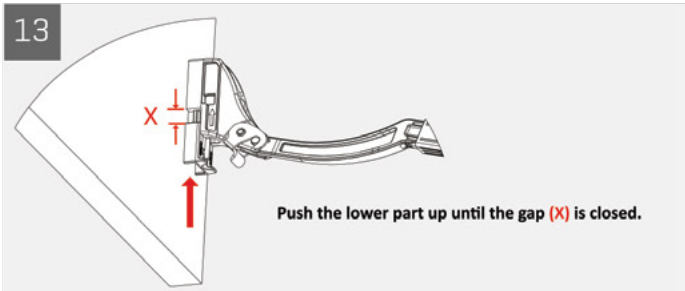
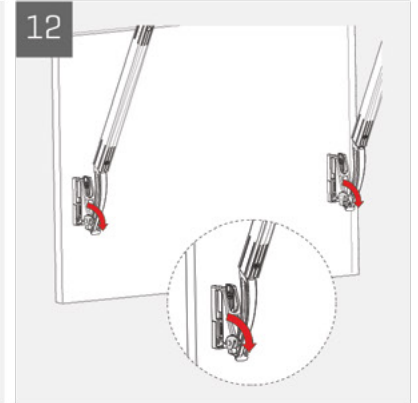
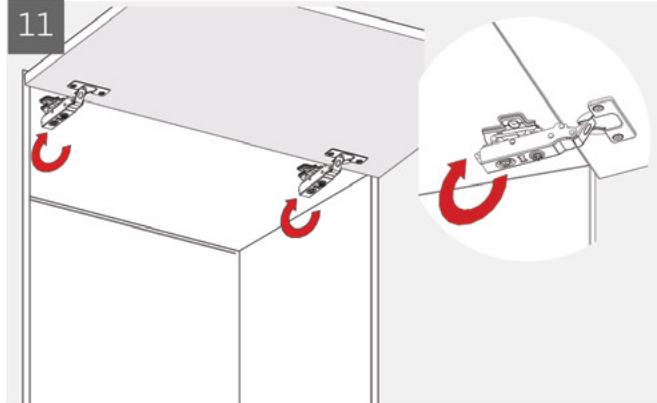

Adjustment

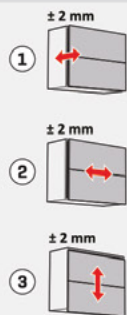
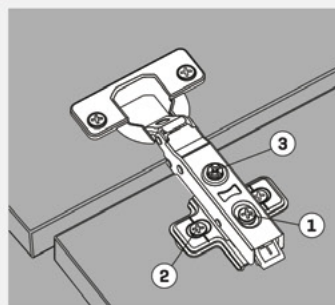

Left&right, up&down and back&forward adjustment can be done as shown in the image for better alignment.

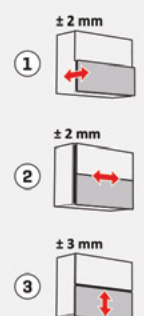
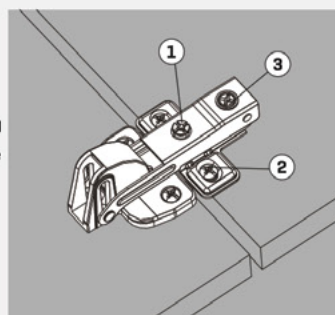

Power Adjustment for Door Weight

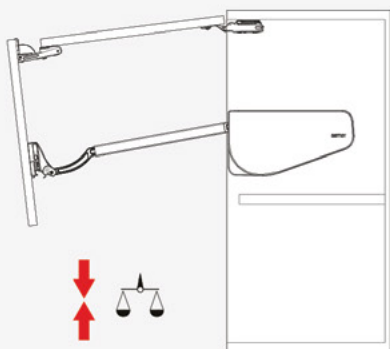

For increasing the power of the mechanism, please make the adjustment on positive direction.
For decreasing the power of the mechanism, please make the adjustment on negative direction.

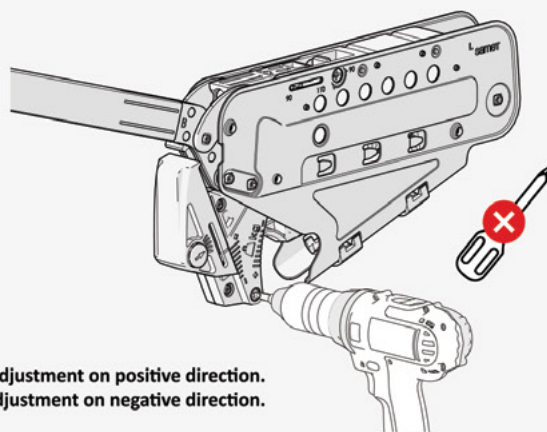

Opening Angle Adjustment

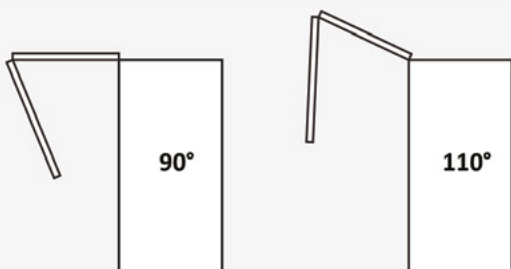

Important Note: Please make the opening angle adjustment with a manual screwdriver with a #2 Pozzi drive tip.

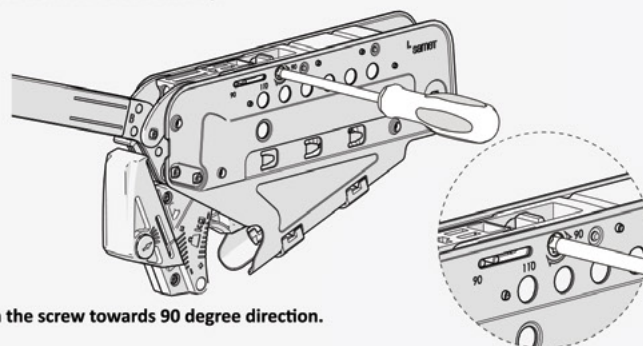

Please make sure to place the pins on the preferred opening angle.
For 90 degree opening, please lower the doors below 90 degree angle and then turn the screw towards 90 degree direction.
For 110 degree opening, please turn the screw towards 110 degree direction.

Soft Closing (Damper) Adjustment

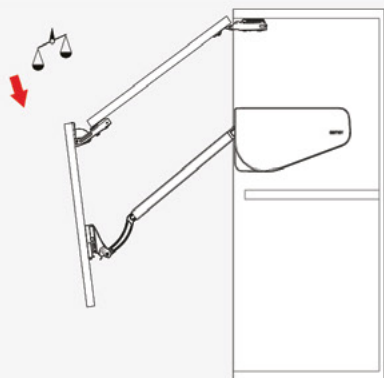

1 Take out the damper safety pin.

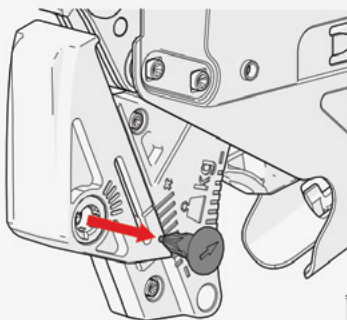

2

Adjustment on negative direction ensures faster door closing effect, adjustment on positive direction ensures slower door closing effect.

3 Place the damper safety pin.

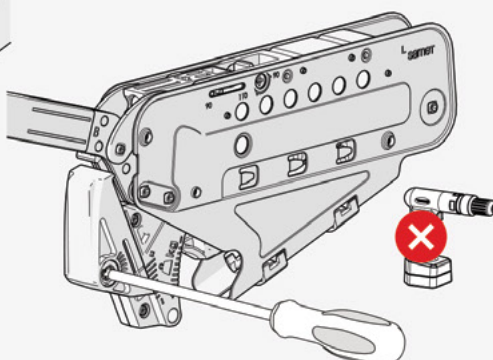
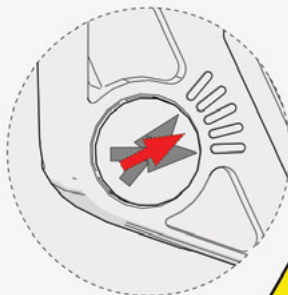
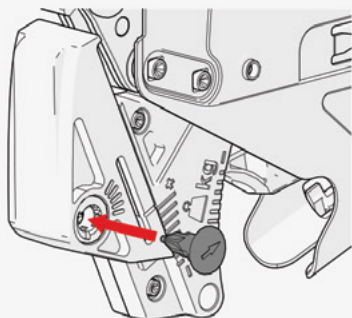

Important: Do not make the adjustment with a power screwdriver or a power drill.



Please pay attention to the arrow sign for placing the damper safety pin.

Prikaz proizvoda na fotografijama može da ne odgovara u potpunosti originalnom uzorku.
Za originalan uzorak proizvoda obratite se vašem Darex prodavcu.



www.darex.rs